

# HS Valve

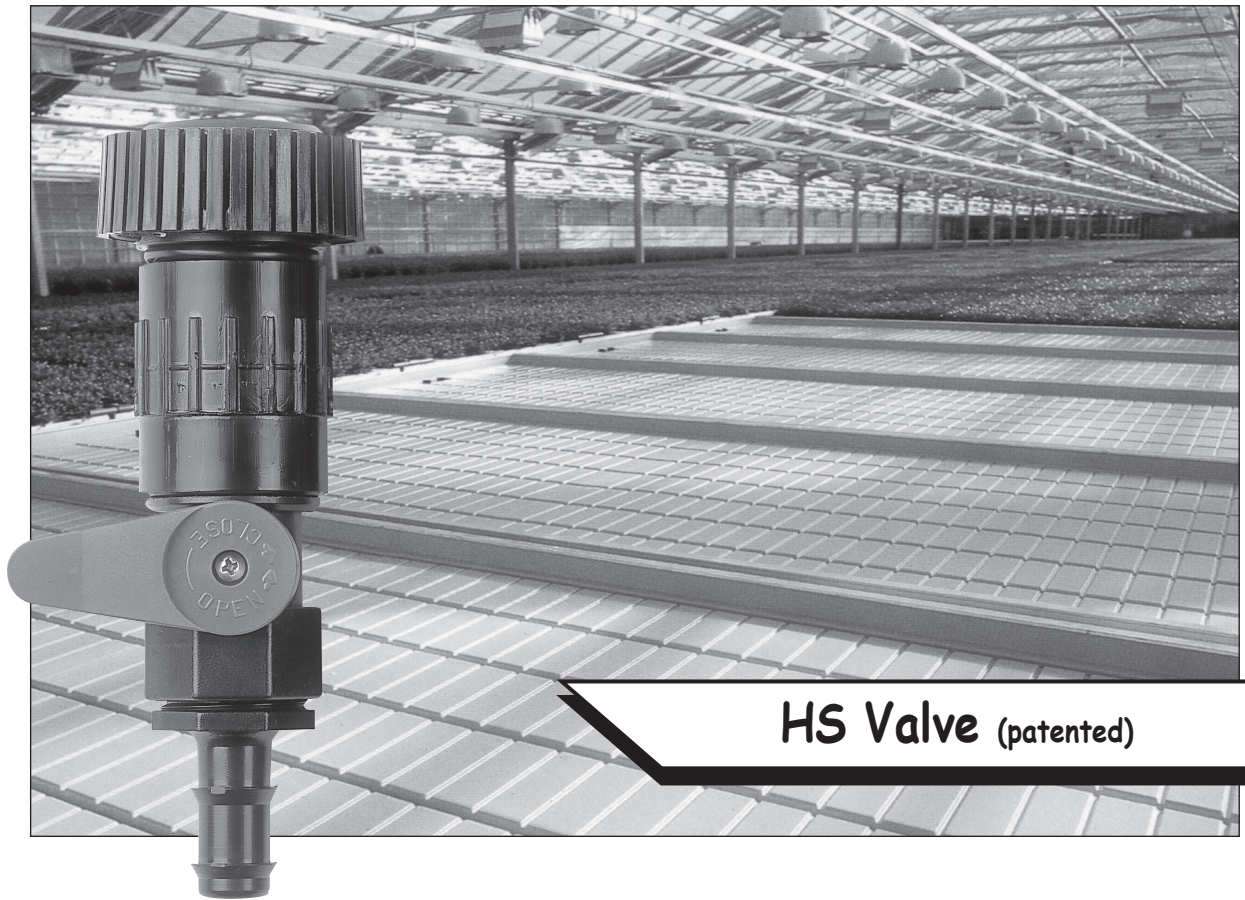

**HS Valve** (patented)

## **Table valve for ebb/flow systems**

The following advantages apply to the HS Valve:

- The HS Valve ensures an equable supply of water and nutrient solution for the plants on every table
- Available with 2-6 mm drillings for supply of nutrient solution
- Different connection possibilities

The HS Valve was patented in 1981 and thereby is a tested product, which is sold the world over with great succes.

# HS Valves

Standard hole size: 3,5 mm

Item no.: 0750700

HS Valve with PE branch.  
Available with 2 types of gasket  
connector branch:  
- for 6x8 hose  
- for 8x10,5 and 10x12,5 hose

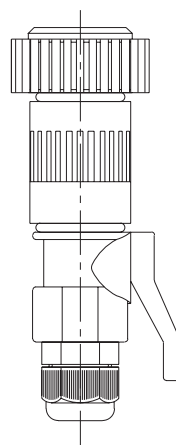

Item no.: 0750703

HS Valve with 1/2" hose branch.

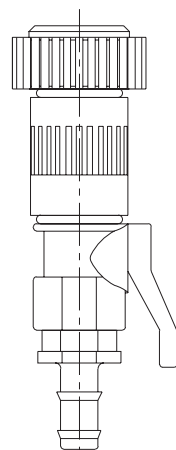

Item no.: 0750704

HS Valve with 3/4" hose branch.

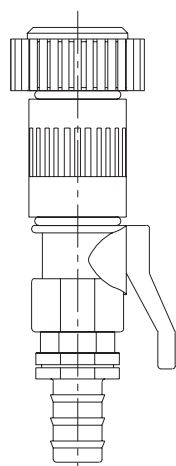

## Diagrams:

### Inlet:

#### Filling capacity diagram for the HS Valve (Litres/Min.)

Pressure in bar									
4,0	2,95	5,35	7,65	11,50	14,60	19,35	22,35	25,75	31,25
3,5	2,85	5,05	7,25	10,50	13,70	18,15	21,00	24,35	28,85
3,0	2,65	4,85	6,85	10,00	12,90	17,15	19,75	22,70	27,30
2,5	2,55	4,72	6,68	9,68	12,20	15,95	18,75	21,75	24,15
2,0	2,40	4,42	6,24	9,00	11,60	14,30	17,15	19,50	21,35
1,5	2,32	4,14	5,80	8,10	10,40	11,75	15,05	17,15	18,75
	2,0	2,5	3,0	3,5	4,0	4,5	5,0	5,5	6,0

Hole diameter in valve cone (mm)

### Outlet:

#### Outlet capacity diagram for the HS Valve (Litres/Min.)

Hole diameter in valve cone (mm)				
2,0	1,70	3,50	5,00	6,00
2,5	1,70	3,50	5,00	6,00
3,0	1,70	3,50	5,00	6,00
3,5	1,70	3,50	5,00	6,00
	6,0	8,0	1/2"	10,0

Inside diameter in hose (mm)  
Length = 1,5 m



# Spareparts

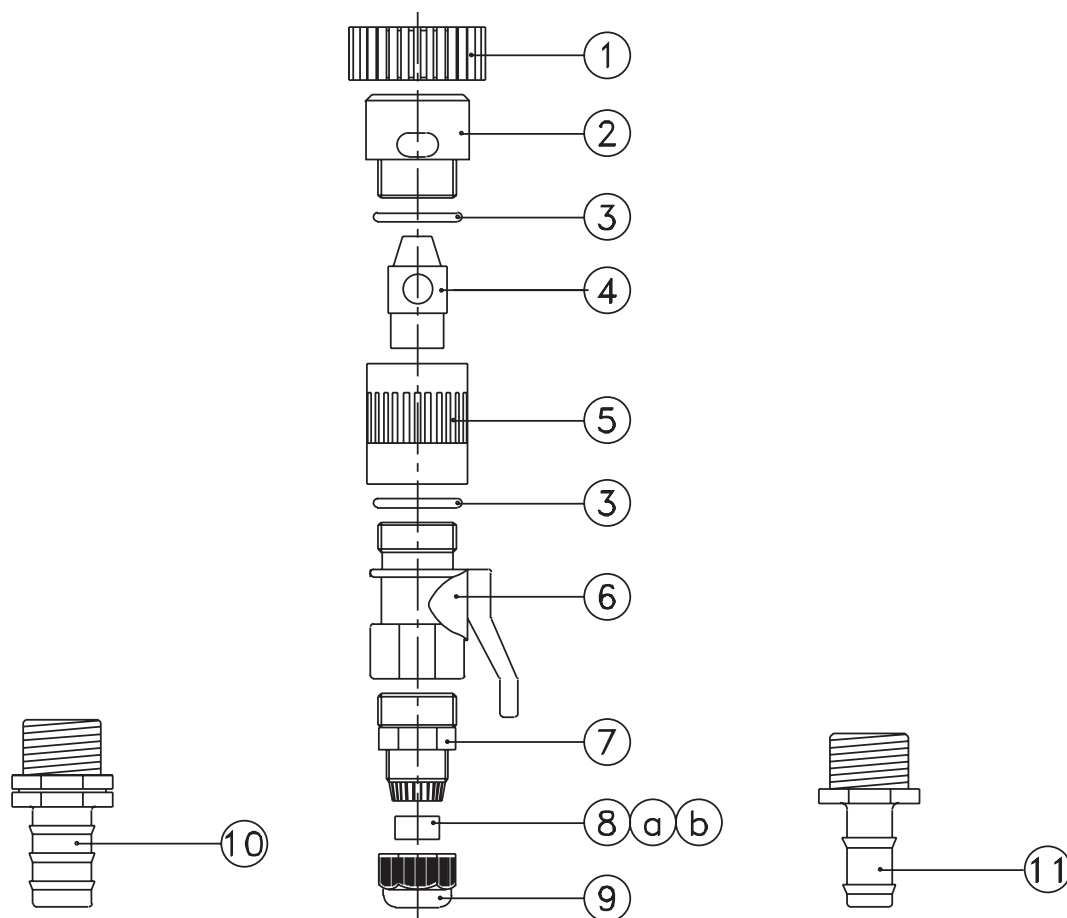

Description			Dimension	Item no.
11	1	Hose branch	3/4" x 16 mm	0760715
10	1	Hose branch	3/4" x 20 mm	0760716
09	1	Union nut		0760706
08b	1	Gasket branch	6x8	0760708
08a	1	Gasket branch	8x10,5, 10x12,5	0760707
07	1	PE branch		0760725
06	1	Ball valve	3/4"	0760740
05	1	HS connector		0760750
04	1	HS cone		0760730
03	1	HS O-ring		0760780
02	1	HS top		0760710
01	1	HS filter		0760770